

# 100 U字溝 - 1種蓋

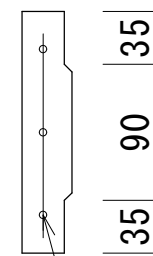

縦鉄筋  $\phi 2.6$  3本

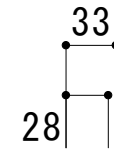
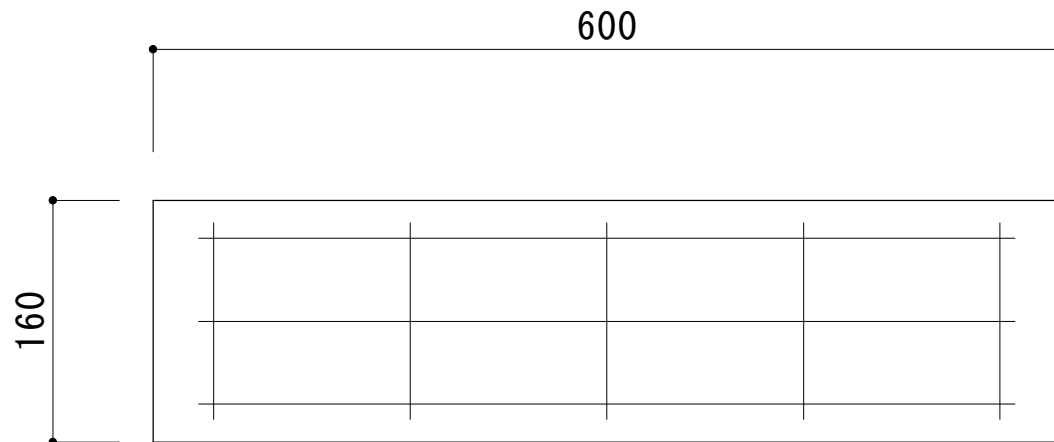
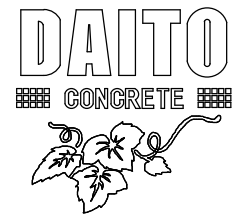
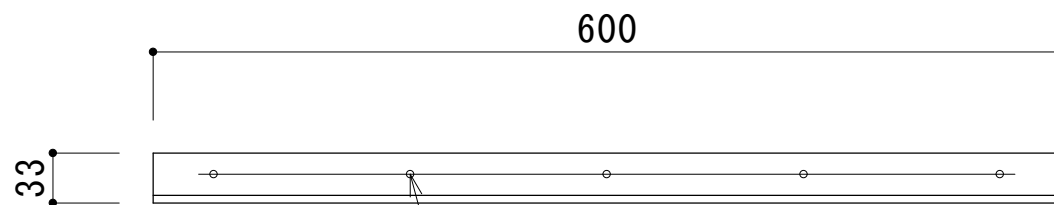

横鉄筋  $\phi 2.6$  5本

品名	100 U字溝 - 1種蓋
寸法 (mm)	160 × 600 × 33
重量	6kg

150・180・300・360・600

# U字溝 - 1種蓋

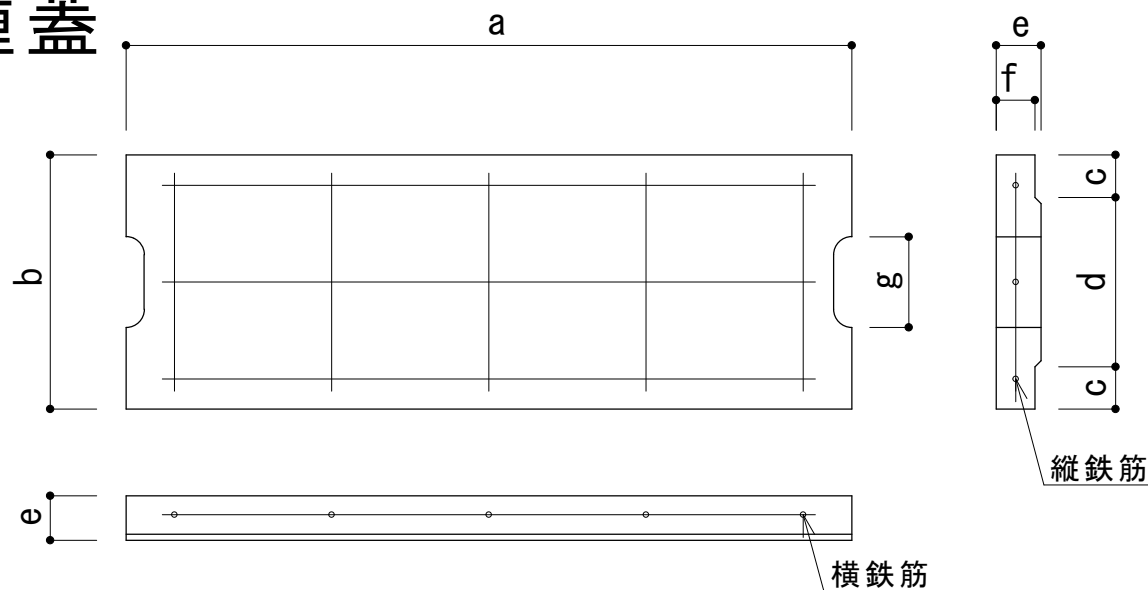
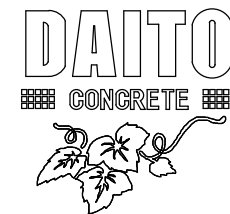

種類	呼び名	重量	寸法 (mm)							鉄筋			
			a	b	c	d	e	f	g	縦鉄筋		横鉄筋	
										径	本数	径	本数
1種	150-U 蓋	10kg	600	210	35	140	37	32	75	2.6	3	2.6	5
	180-U 蓋	12.5kg	600	250	40	170	40	35	80	2.6	3	2.6	6
	300-U 蓋	33kg	600	400	55	290	60	50	100	3.2	4	4.0	6
	360-U 蓋	41kg	600	460	55	350	65	55	120	3.2	4	5.0	6
	600-U 蓋	77kg	600	740	75	590	75	65	150	4.0	6	6.0	6

# 150 U字溝 - 1種蓋

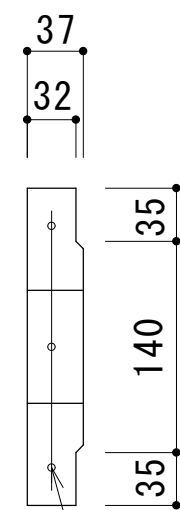
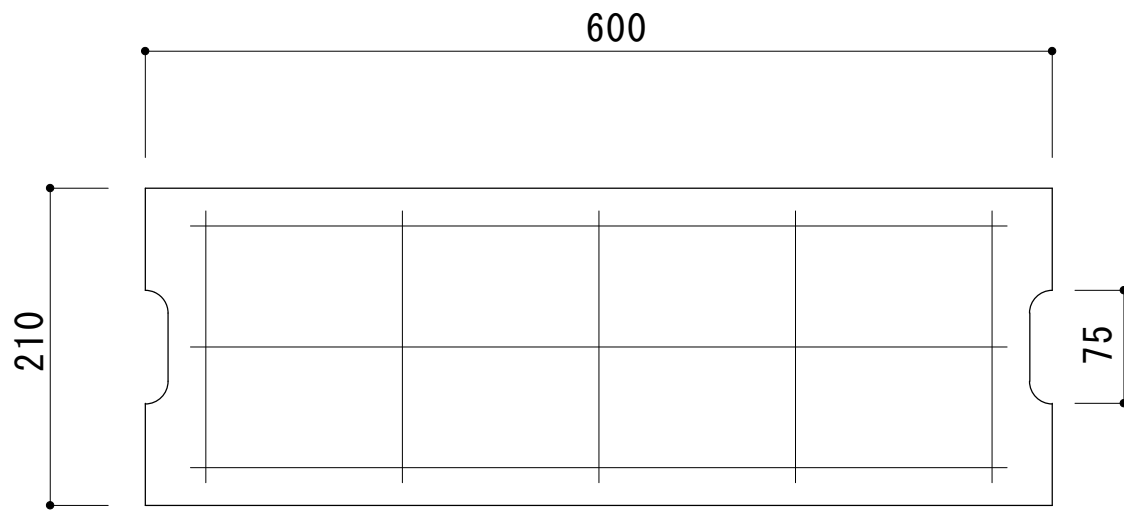
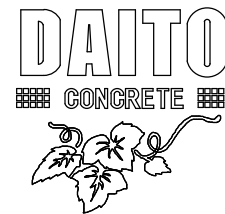

縱鉄筋  $\phi 2.6$  3本

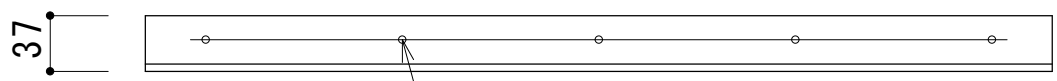

横鉄筋  $\phi 2.6$  5本

品名	150 U字溝 - 1種蓋
寸法 (mm)	210 × 600 × 37
重量	10kg

# 180 U字溝 - 1種蓋

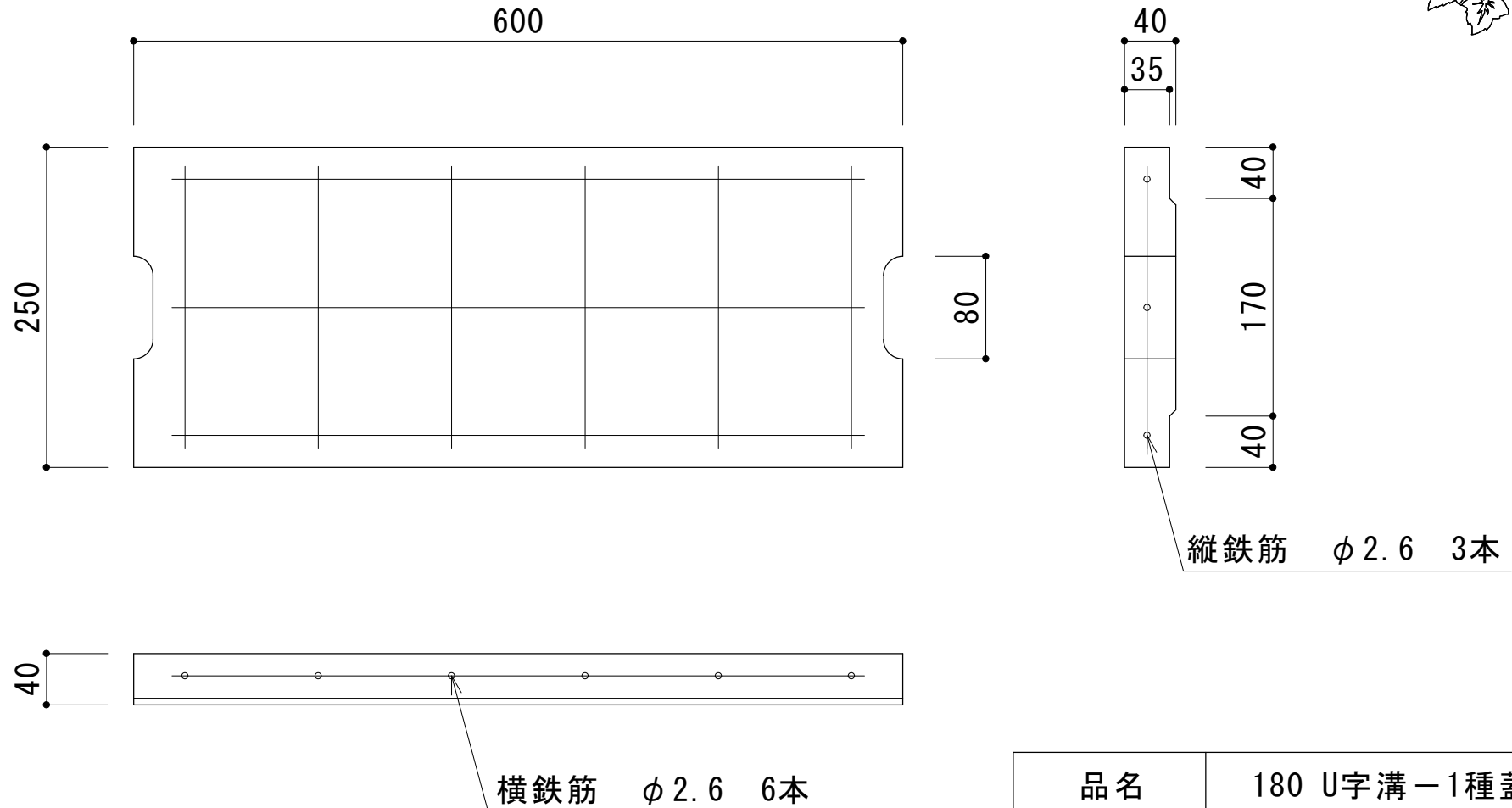
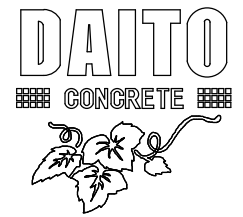

品名	180 U字溝 - 1種蓋
寸法 (mm)	250 × 600 × 40
重量	12.5kg

# 300 U字溝 - 1種蓋

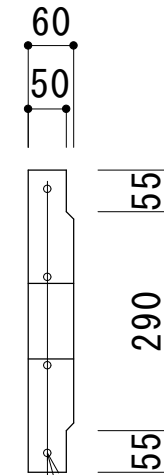
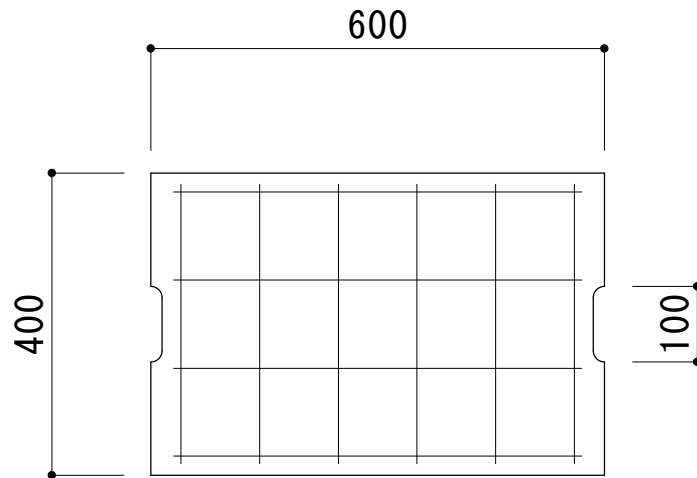
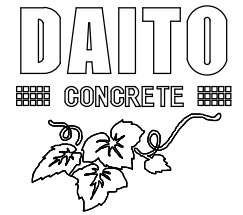

縱鉄筋  $\phi 3.2$  4本

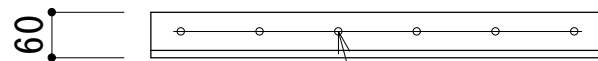

横鉄筋  $\phi 4.0$  6本

品名	300 U字溝 - 1種蓋
寸法 (mm)	400 × 600 × 60
重量	33kg

# 360 U字溝 - 1種蓋

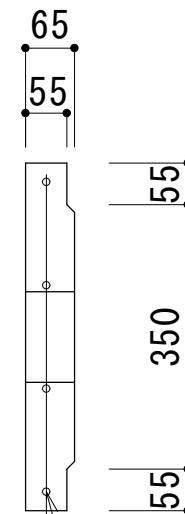
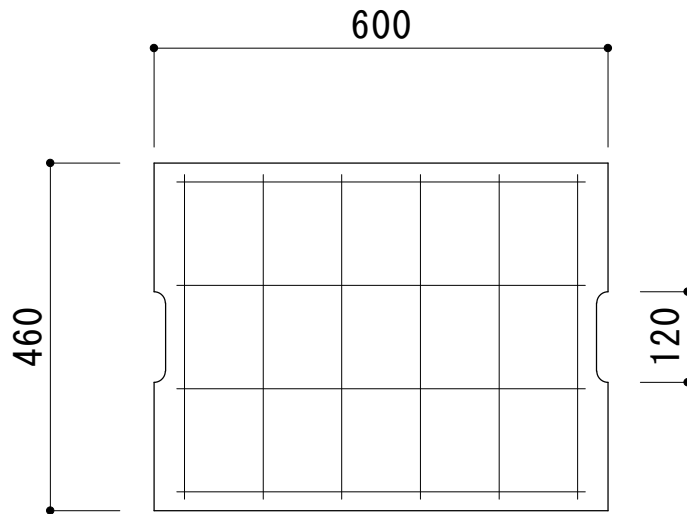
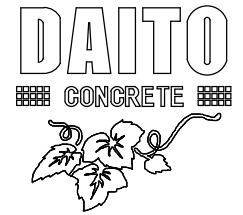

縱鉄筋  $\phi 3.2$  4本

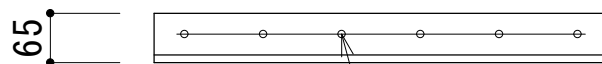

横鉄筋  $\phi 5.0$  6本

品名	360 U字溝 - 1種蓋
寸法 (mm)	460 × 600 × 65
重量	41kg

# 600 U字溝 - 1種蓋

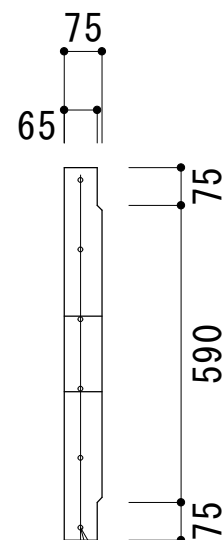
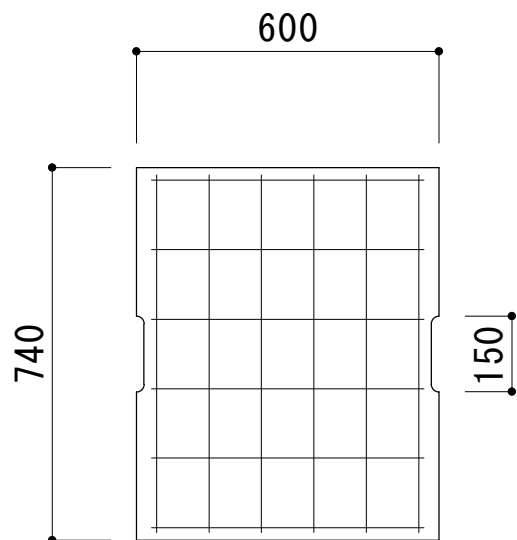
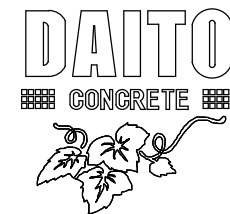

縱鉄筋  $\phi 4.0$  6本

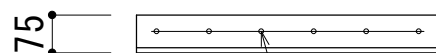

横鉄筋  $\phi 6.0$  6本

品名	600 U字溝 - 1種蓋
寸法 (mm)	740 × 600 × 75
重量	77kg